

Data sheet

Support roller NATV 8 PP (crowned, with axial guidance, full needle, seal)

Designation	NATV 8 PP
Type	crowned
D [mm]	24
d [mm]	8
d1 [mm max.]	19
B1 [mm]	15
B [mm]	14
r [mm]	0,3
Dynamic load Crw[N]	7800
Static load C0rw[N]	11400
Speed limit [min-1]	5500
Speed limit [min-1]	11000

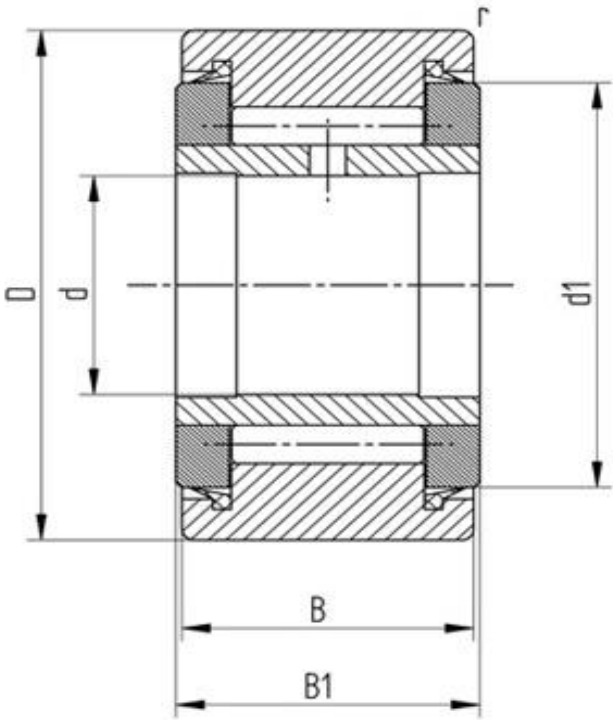

Every specification has been edited and verified carefully. STI Bearings GmbH assumes no liability for potential errors or incompleteness. Technical modifications are subject of changes.

© 2020 by STI Bearings GmbH

Reproduction, even excerpts, only with our approval.